



## Assembly Instructions

### Infeed and Outfeed Tables (Stock No. 98-2202)

for use with Model 22-44 Plus Drum Sander

Numbers in parentheses refer to Figure 2 and the breakdown on reverse side.

1. Bolt the base bracket (2) to the sander with two 3/8"-16 x 1" hex head cap screws (3) and two 3/8" flat washers (4). Tighten the screws.
2. Mount the table (1) to the base bracket (2) with four 1/4"-20 x 3/4" carriage bolts (5), four 1/4" flat washers (6) and four 1/4" hex nuts (7). **Note:** Leave the carriage bolts loose for now.
3. Place a straight edge on the conveyor bed and extending out over the extension table. Raise or lower the extension table until it is level with, or slightly below, the surface of the conveyor belt. Tighten the hex nuts (7).
4. Repeat for the opposite side.

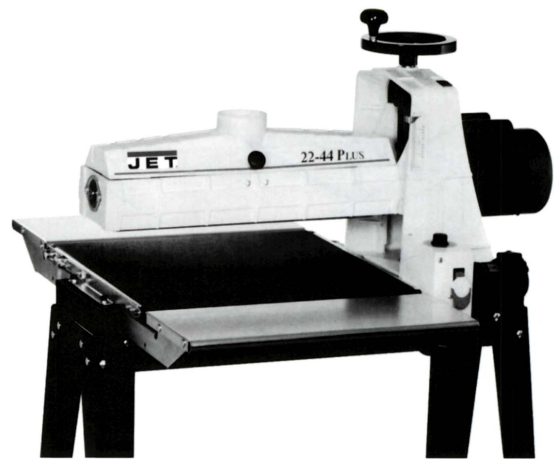

Figure 1

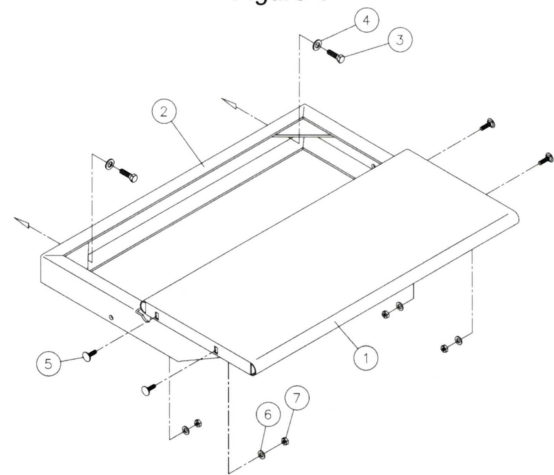
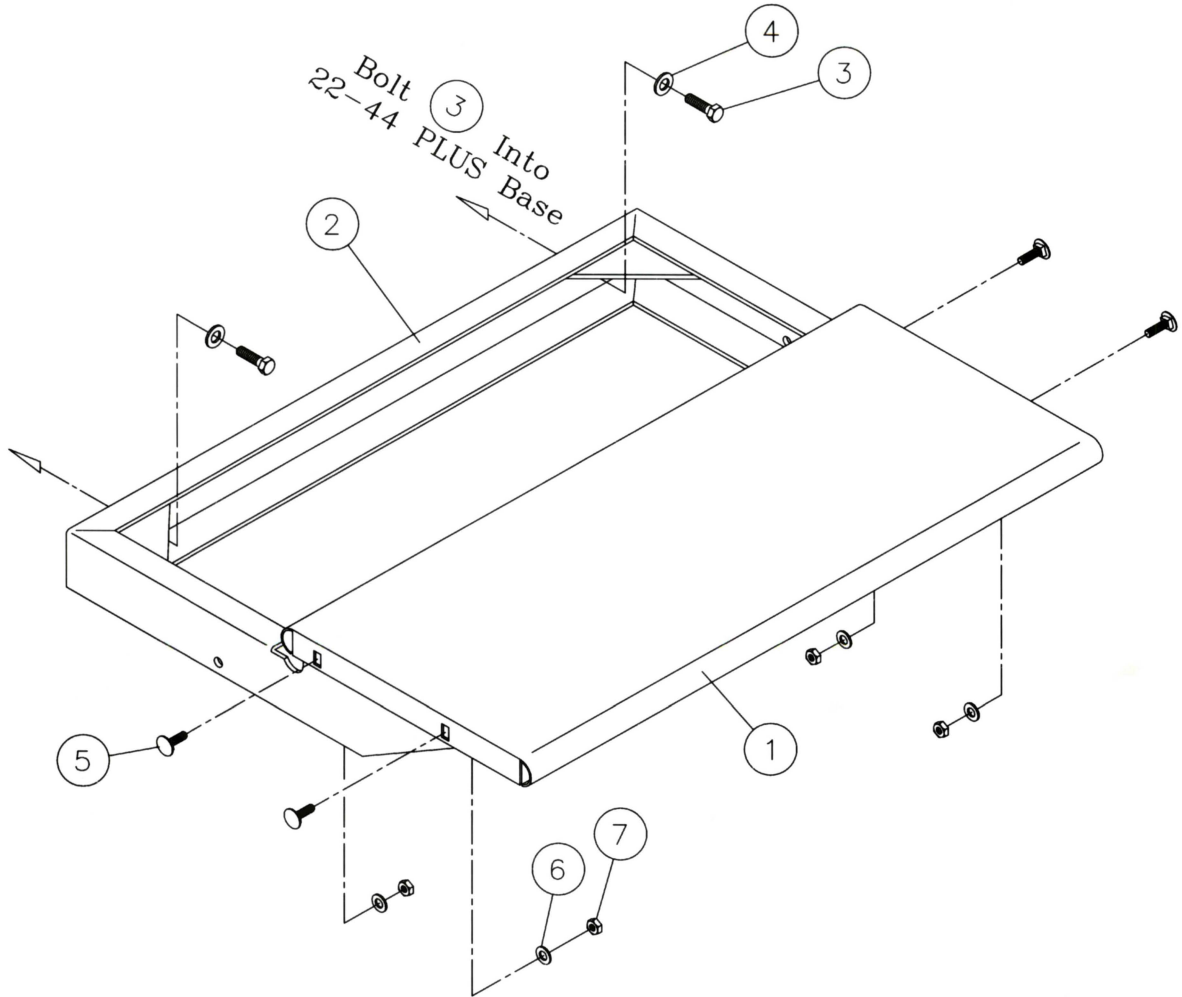

Figure 2

**WALTER MEIER (Manufacturing) Inc.**  
427 New Sanford Road  
LaVergne, Tennessee 37086  
Ph.: 800-274-6848  
www.waltermeier.com

**Part No. M-98-2202**  
Revision C1 02/2010  
Copyright © 2010 Walter Meier (Manufacturing) Inc.

## Parts Breakdown for the 22-44 Plus Infeed and Outfeed Table



Index No.	Part No.	Description	Size	Qty.
1.....	2244PLUS-501.....	Table .....		2
2.....	2244PLUS-502.....	Base Bracket.....		2
3.....	TS-0060051 .....	Hex Head Cap Screw.....	3/8"-16UNC x 1" .....	4
4.....	TS-0680041 .....	Flat Washer.....	3/8".....	4
5.....	2244PLUS-505.....	Carriage Bolt .....	1/4"-20UNC x 3/4" .....	8
6.....	TS-0680021 .....	Flat Washer.....	1/4".....	8
7.....	TS-0561011 .....	Hex Nut.....	1/4".....	8